

BR 02

Cast iron element for vertical (V), supplied with M8 upper and lower threaded hole. Surface protection: sandblasting, one component zinc coat by immersion, two-component zinc phosphate primer coat, two bicomponent finishing standard gray paint (**S**) or with RAL colors on request.

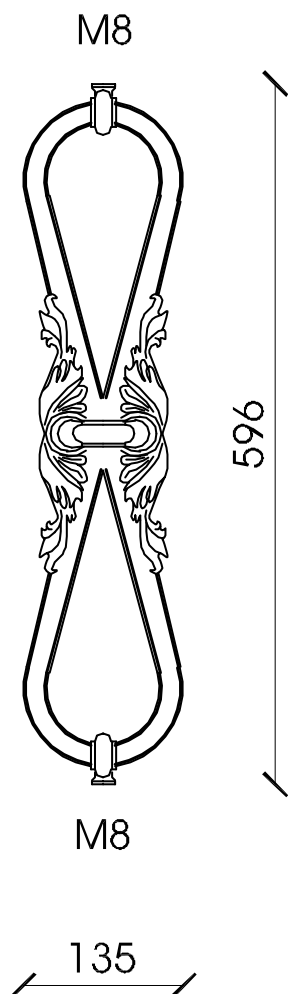

BR 02 VS

Vertical fixing element

MATERIAL

Cast iron casting GLJ-200 (UNI EN 1561)

WEIGHT

Kg. 3,5

INSTALLATION EXAMPLES

ACCESSORIES

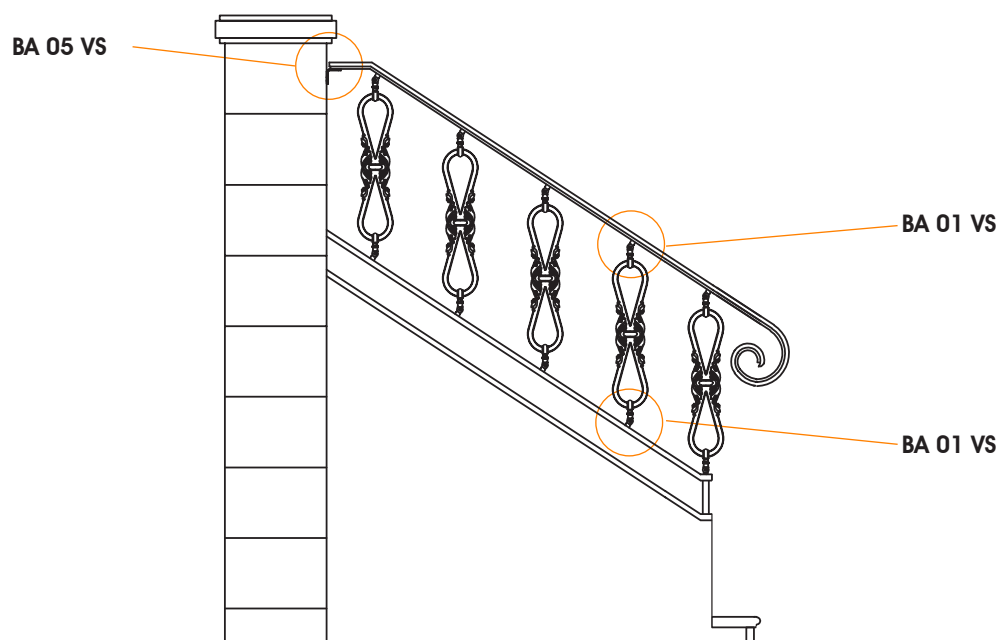

STEEL PROFILE VERTICAL FIXING **BR 02 V**

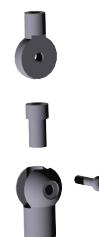

BA 01 VS
UPPER FIXING



BA 05 VS
WALL FIXING