

LPA 011 ALUMINIUM POLE

1:25 SCALE

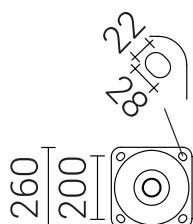
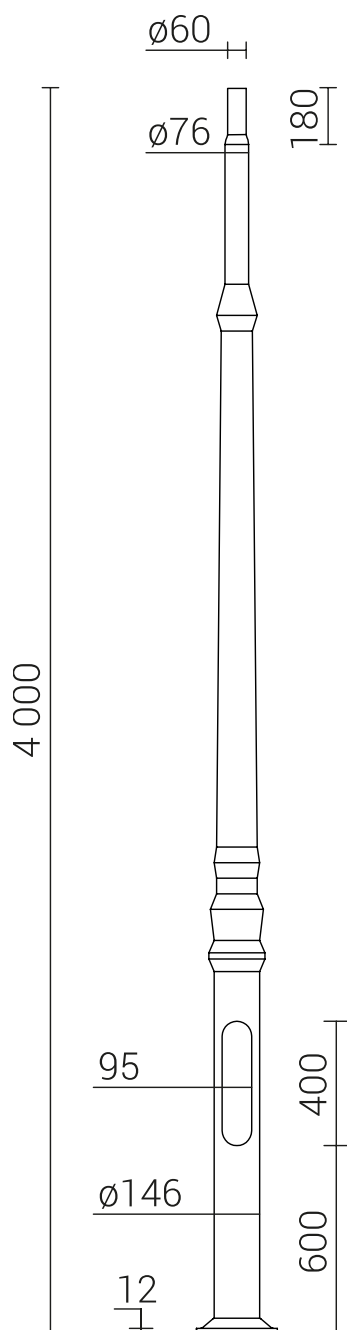

LPA 011 F
Pole with Flange

DESCRIPTION

STRUCTURE

Alloy aluminum EN AW 6060 pole equipped with hatch for wiring compartment.

Aluminum EN AW 5754 base 260/200/8 mm.

Pole body 146/76/60 mm.

Stainless steel hardware.

FINISHING

Aluminum grinding, protection option with elastomer in the same color as the pole up to the height of 350 mm. (another height at customer's request).

For details on ground anchorage, refer to the technical drawing.

ANODIZING PROCESS

Anodizing in 10 colors with the possibility of brightening consisting of the formation of an oxide layer on the surface of the metal by means of electrochemical method.

TECHNICAL DATA

HEIGHT m	THICKNESS mm	WEIGHT Kg	BASE mm	TOP' mm	FLANGE mm	FOUNDATION/ ARMATURE CAGE
4	3	20,8	146	60	260x260	LFB510 / LFZ510



PASSIVE SECURITY | Class 100NE2

No Resistance



FLANGE DETAIL

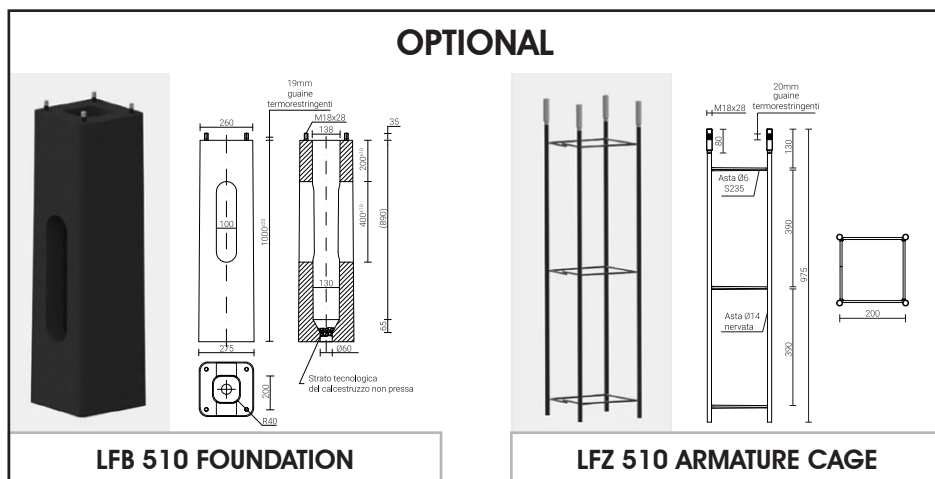

LFB 510 FOUNDATION

LFZ 510 ARMATURE CAGE

ANODIZING CODES



C35

BLACK



C175

GREEN



C163

GREY



C165

GRAPHITE



C34

BROWN



C178

ANTHRACITE



C33

OLIVE



C32

CHAMPAGNE



C45

INOX



C0

NATURAL